

العمارة البيزنطية

# Byzantine Architecture

Dr. Kamal Elgabalawy

**THE REFERENCES TO MULTIPLE SOURCES ARE TEXT & FIGURES**

**(SKETCHES, DRAWINGS, PICTURES, PHOTOS,...ETC.)**

**ALL THE RIGHTS BELONG TO ORIGINAL AUTHORS**

# The Eastern Empire

# Comparison

# The Western Empire

## Hagia Sophia Dome, Istanbul / Turkey

## The Pantheon Dome, Rome / Italy

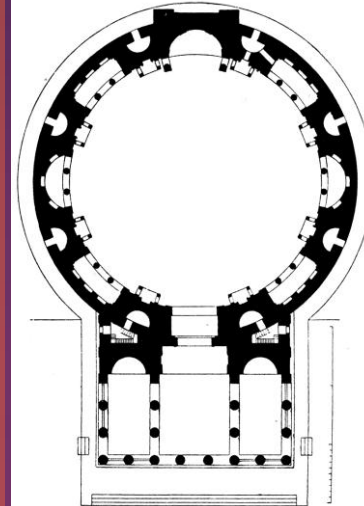
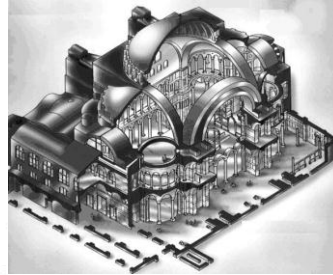
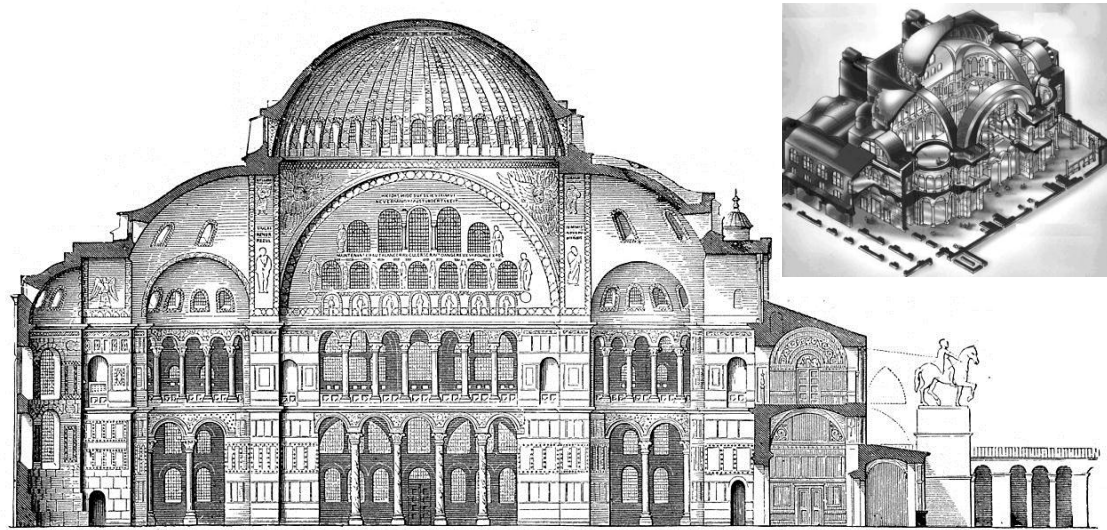

12. ROM: PANTHEON.

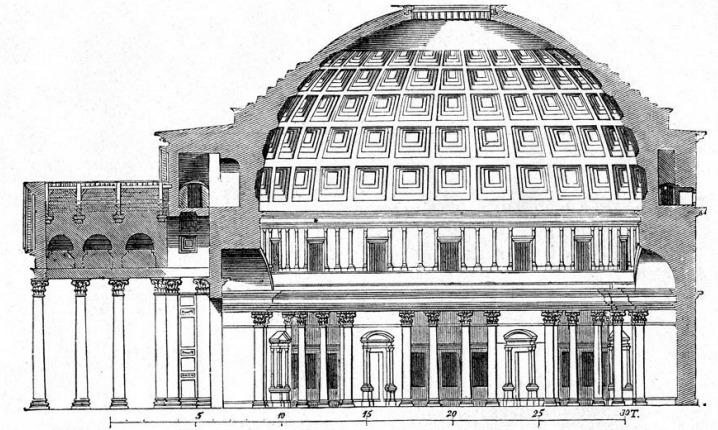

13. The Pantheon at Rome. Section. Built 26 B. C., restored 202 A. C.

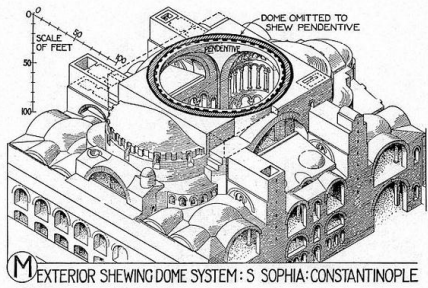

M EXTERIOR SHEWING DOME SYSTEM: S SOPHIA: CONSTANTINOPLE

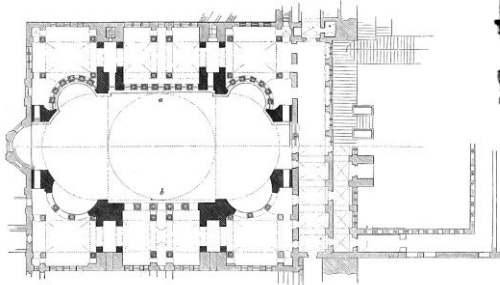
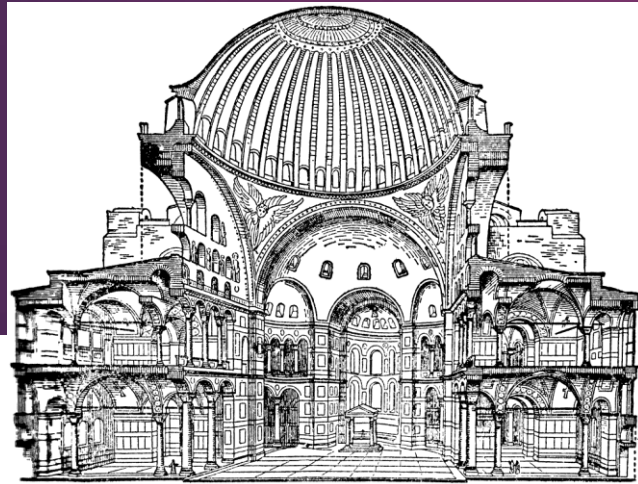

العمارة البيزنطية

# Byzantine Architecture

*THANK YOU*

Dr. Kamal Elgabalawy

**THE REFERENCES TO MULTIPLE SOURCES ARE TEXT & FIGURES**

**(SKETCHES, DRAWINGS, PICTURES, PHOTOS,...ETC.)**

**ALL THE RIGHTS BELONG TO ORIGINAL AUTHORS**